

# VASTU TIMES

Designing & Building of  
MEDITATIVE SPACES

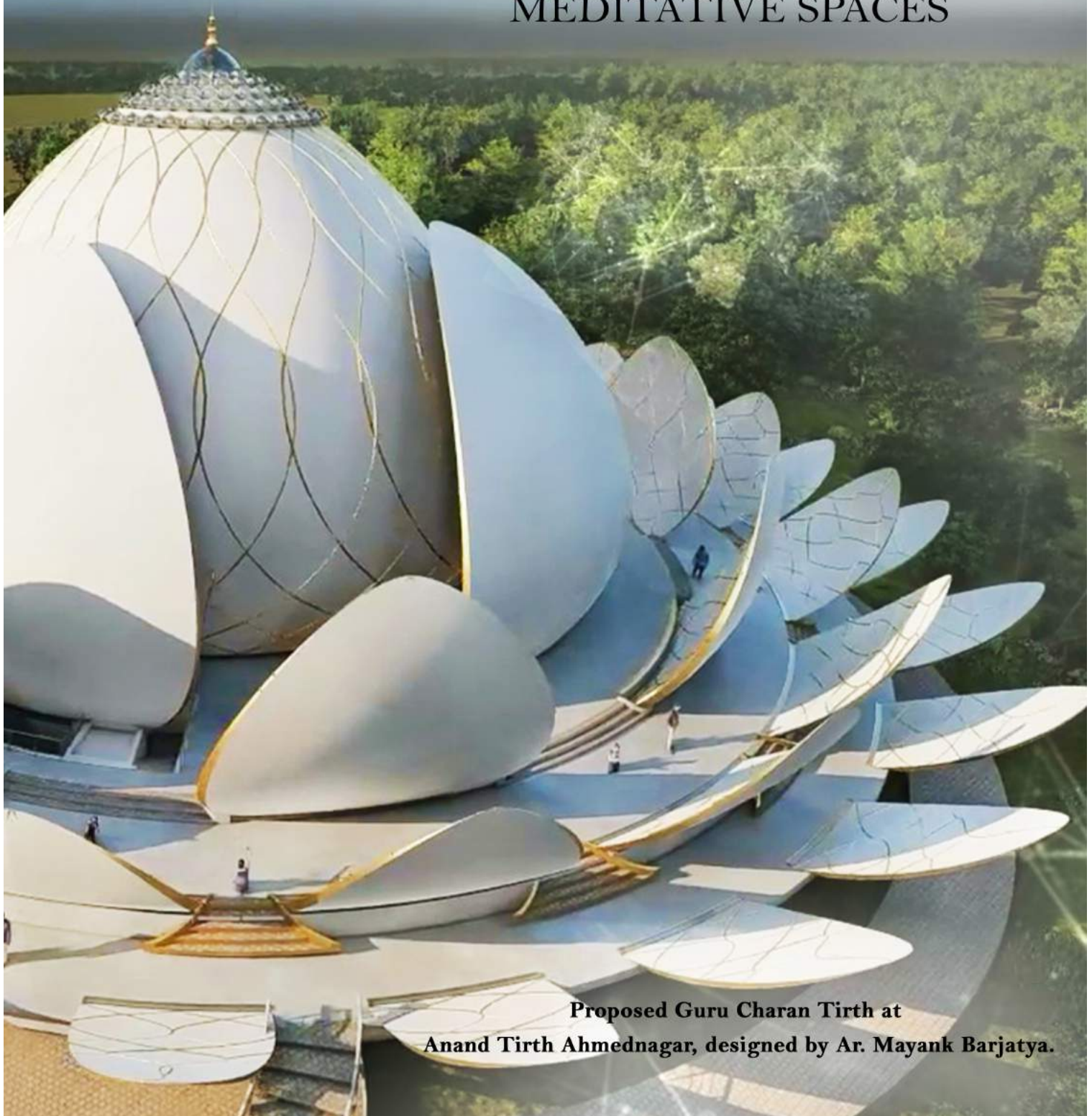

**Proposed Guru Charan Tirth at  
Anand Tirth Ahmednagar, designed by Ar. Mayank Barjatya.**

## Editor's Desk –

Lots of learnings in the year gone by , among everything that I read , one word got caught on to me and has really grown on me .....

### Amor Fati

Amor fati is a Latin phrase that may be translated as "love of fate" or "love of one's fate". It is used to describe an attitude in which one sees everything that happens, including suffering and loss as, necessary. Whether one likes them or not; it is accepted with zen like serenity.

To quote this with an example as below - Thomas Edison was at home eating dinner. A man burst into his home, interrupting him. He had bad news. His research facility was on fire.

Now how would you imagine Edison to react? Do you imagine Edison panicking or do you hear him screaming out "Why me?" or is he deeply distraught or do you see him in deep agony?

None of these happened. Edison requested his son to go and get his mother. It seems, Edison excitedly told his son, "She'll never see a fire like this again."

Naturally, Edison's son thought his father had lost his mind, and rightfully so. All of Edison's experiments, things that could never be replicated, were inside his laboratory, burning to the ground.

Don't worry. It's all right," Edison said calmly, "All my mistakes and a lot of unnecessary rubbish have just got burnt."

In this, Edison revealed the true nature of Amor Fati – choosing to love your fate, no matter what.

Not only was he "NOT broken-hearted", he was revitalized. Despite losing over \$1 million at the age of 67 in that fire, he persevered and made over \$10 million thereafter. WOW!



I am in love with the concept of Amor Fati. Why? Because, the power that we have in life by accepting our fate is so immense that you feel nothing is impossible for you. You believe that everything has a purpose, and that it is up to you to make this purpose something positive and active.

Maybe you lost your job.

Maybe someone cheated you of your entire life's earnings.

Maybe, your trust was broken with impunity.

Maybe, the person you love the most, is facing a life-threatening disease.

Maybe, someone ill-treated you.

The challenge of your life may be considerable and inescapable and yet you're given the choice to greet it with a smile. And then, act. That's AMOR FATI.

I know most of the times it's difficult to view situations with this kind of objectivity especially when these are nerve racking or heart wrenching moments.

However, I believe when we accept this calamity with this calmness, though it may seem unnatural at that time, it acts like a fuel to push harder. It is fuel for you to work harder when you want to quit. It is fuel for you to think big when nothing was going right. It is fuel for you to smile when all you want to do is frown.

After all when you look back on these incidents you realize these were pit stop moments in your journey leading towards exactly to where you are meant to be.

Amor Fati, my dear friends!

This year like the previous years has been eventful, lots of new things, New innovations, New ideas, New remedies and new tidings across the seas.

Expansion of our Prithwe Earthing Center, off-site workshops at Prithwe, path breaking Jain Architectural space designed by Mayank and last but not the least, International exposure at G20 Summit in Bali.

In This issue sharing some of the Iconic Events.

Vrushali Kute  
Editor



## Bali – Events

As they say success comes to those who dare to be different and Mayank has always been one to stand out from the crowd and be a forerunner.

He was a part of the G20 Summit – 2022 held in Bali with along his Spanish counterpart – where they were showcasing Bio Energetic Architecture. What better platform to showcase the Bioenergetic and the concept of Harmonized homes.

The Event was attended by lots of foreign dignitaries and the podium garnered a lot of interest, people were especially very interested in getting their Bio energetic profiling done.



Media coverage - Sharing excerpts from the article published in Indonesia's National Newspaper

## Rakyat Merdeka

Bio-Architecture is the art and science of designing spaces inspired by the energetic principles of nature. The exhibition showcases natural materials made from agricultural waste and by-products, which can help improve the energy of the home/work place thereby creating a healthier space.

" While delving deeply into the ancient building knowledge documented by our ancestors, we live in caves and are surrounded by rocks and natural energy. It is very important to make us feel connected to our environment in today's chaotic world, by creating a home and work place that can meet our needs for happiness, peace and balance in life. It has been scientifically proven, based on the principles of Bio-Energetic architecture we will get balance in life when surrounded by natural energetic materials,"

-Mayank Barjatya

For this Bio-Energetic Architecture exhibition, Mayank continued, his party developed a hybrid bio-living building with a roof, walls and floor structure made of basalt, recycled paper pulp, and reinforced with natural bio-epoxy.

G20 delegates doing activities



The materials form a strong hybrid structure, with 2.5 times the strength of alloy steel and 1.5 times the strength of glass fiber. Basalt is 4 times lighter than steel, but 2.5 times stronger. Fireproof; anti-fungal; waterproof; and even bulletproof if asked; earthquake and storm resistance as well as providing electromagnetic protection(G5)"

-He said

Basalt is a volcanic rock that is much closer to the Earth's surface than any other type of rock, and is similar to the basalt found on Venus and Mars. Basalt is a type of dark volcanic igneous rock that forms from the rapid cooling of lava.

"Basalt helps ground you to the ground and is an excellent healing medium when dealing with significant life changes. When surrounded by basalt, it can help you overcome difficult transitions, providing confidence, stability and support. Providing a transformational energy for you." He explained.



The exhibition also displays several example of agricultural waste materials used in the building industry. As well as solar panels made from papaya waste and furniture from corn.

## Alchemy Space

According to Mayank, bio-energetic architecture reveals that a person is a reflection of his own living space. Bio-energy and geobiology measure earth, human energy and chakras. "A question in bio-energetic architecture, which is 'Is this land good for you to build on,'" He said.

"After scanning you and the ground conditions with the H3 Gold Lecher Antenna, it will be decided what tool, design, shape and color will be used to shape and improve your condition. This helps to create balance and harmony between you and your home. Choosing the right energetic building materials can improve and adapt your land as well as your personal problems," He continued.

Bio-energetic architecture is an approach for all the inhabitants of the earth to get back into harmony with their natural environment. It is proven that using energetic structural building materials such as basalt instead of steel, geopolymers such as kenaf concrete, or Reclea bricks made of fly ash will improve our lives.





Delegates and Guests at Vastuworld Enclosure - G20 Summit, 2022

Mayank continued, the use of these materials in Bio- Energetic architecture will reduce the earth's creatures from stress caused by toxic traditional building materials. An approach to the scientific process of creating optimal living and working spaces in our already contaminated environment.

“These bio-energetic ingredients help balance and liven up our homes and workspaces of health, harmony and happiness. These ingredients release us from stress and boost our immunesystem. Most of today's building materials have poisoned our lives and contributed 76% to our body's ailments such as chronic disorders, fatigue, sensitivities, asthma, allergies, sleep problems, nervousness, learning difficulties, low immunity, infertility, and cancer.



## **Geo Biology and Bio Energetic Analysis for a Mega project at Bali –**

**Glimpses and Science of Geo Biology and Bio Energetic Survey: 50 Hectares Project at Bali (Indonesia)**

**Project executed by Ar. Mayank Barjatya along with Ar. Juan Schlosser in Bali.**

**Bio Architecture is an approach for all the inhabitants of the earth to get back into harmony with their natural environment, this can help improve the energy of the home/workplace there by creating a healthier space.**

**Geo Stress mapping is the process of scanning land energies using specific magnetic field detecting devices to identify Positive power spots & Negative geo-stress points.**

**Bio-energetic Interpretation & geo-mapping of the survey is done to establish the feasibility of the construction of the building on these spots.**

**The Geo-biology & Bio-Architecture process is very essential to ensure the new buildings and utility spaces are in energetic balance with the Earth which in turn help to create living and breathing structures.**

**Final outcome is the custom design harmonic Geopathic stress Absorbers and Energy Enhancers to be installed at stipulated defined spots**



**Checking Earth Energies with  
H3 Gold Lecher Antenna**



Ar. Mayank Barjatya and Ar. Juan Schlosser, checking Earth Energies with H3 Gold Lecher Antenna

# Proposed Guru Charan Tirth at Anand Tirth Chichondi, Ahmednagar, Pune

Has been designed keeping in mind Bio Architecture principles.

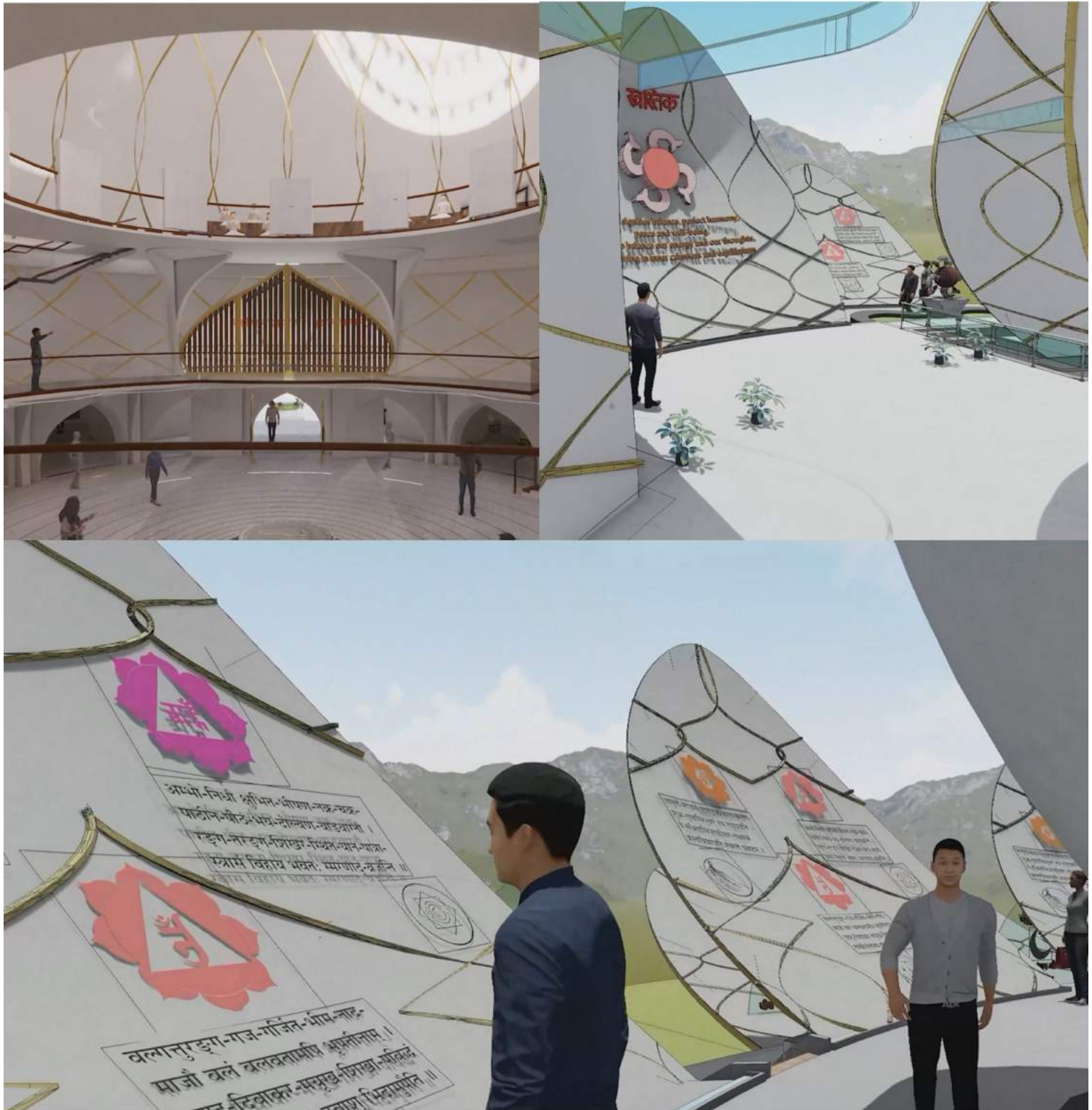



Heliostat Lenses,  
inside Guru Charan Tirth

**Bio Architecture incorporates Bionic Architecture following true science of;**

- 1. Shape Energy**
- 2. Material Energy &**
- 3. Earth Energy,**

**Where earth's models are replicated to create a geo biological conducive & sustainable building, wrapped up in an natural organic architectural form.**

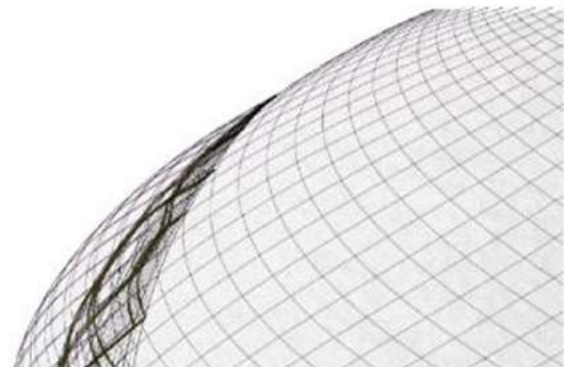
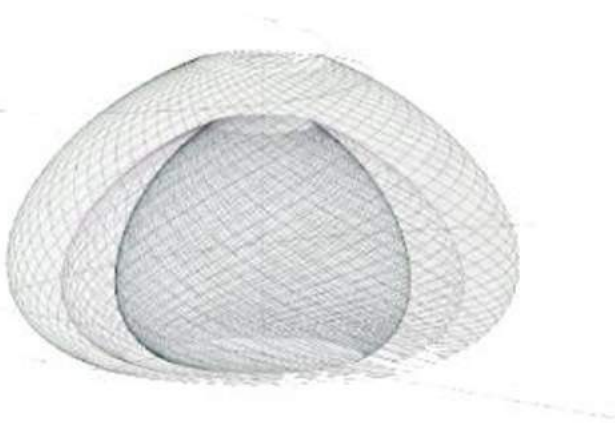

## Bhumi Poojan at Chichondi

Talk given by Ar. Mayank Barjatya on Building Meditative Spaces,

This was shared live on "Rishi Praveen" channel.

Same can be heard here -

<https://www.youtube.com/watch?v=kzXVswclbnQ>



# Proposed Shrut Bhavan Research Institute in Pune designed using natural building material and Bamboo

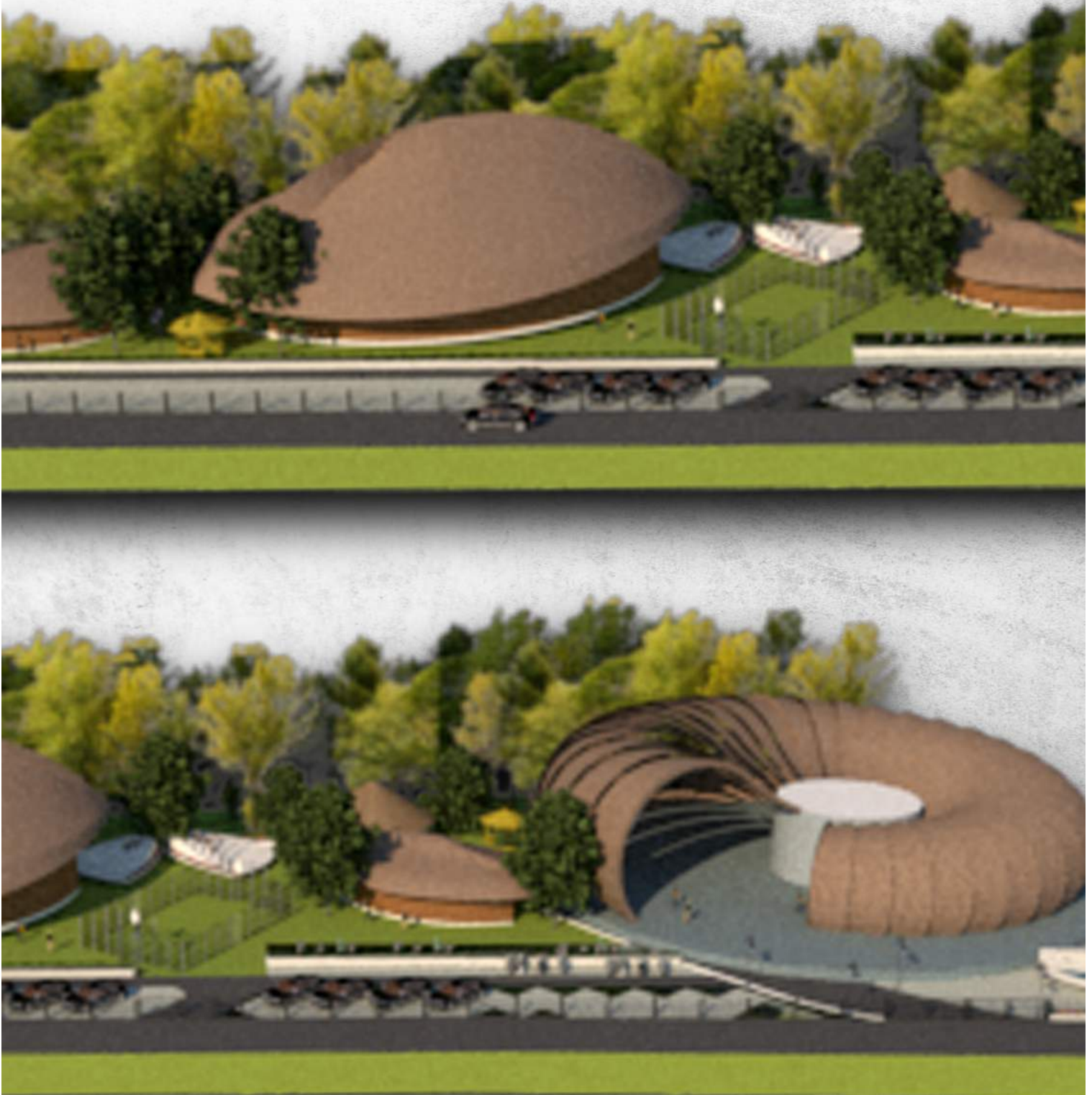

## Rectification of LOST ENERGIES - Reviving Historical Energies



Old Guniyaji Temple

### Energy Preservation and Revitalization of Old / Rebuilt temples -

Stupas are the true Jain Temples and we need to create a design document so that more Stupas are made in modern context, strongly following the Geo-biological norms on sacred spaces with strong energy intent by Acharyas and Jain saints.

Also, in many cases of refurbishment or rebuilding of Old Temples, it has been observed that old structures that had historical vibrations of Tirthankaras and Siddhas, were demolished. The new building on the very same spot has not utilized the morphogenic energies of that space, hence all aura of the divine energy is lost

At Vastuworld during Mayank's years of research on the subject he has found a way to hold these old Divine energies thereby creating a holographic footprint and recreating a similar bioenergetic energy flow.

Thus, restoring them during reconstruction and revitalize it after building is made for today's era. This process involves in-depth study and understanding of Science of these sacred spaces, geopathy and geobiology, identification of power spots, and post that application of bio-resonance remedies. These remedies when applied at specific nodal points, evokes positivity and revokes lost energies.

## One such site project of Energy Preservation is – Guniyaji Temple Communicating with Morphogenic Energies

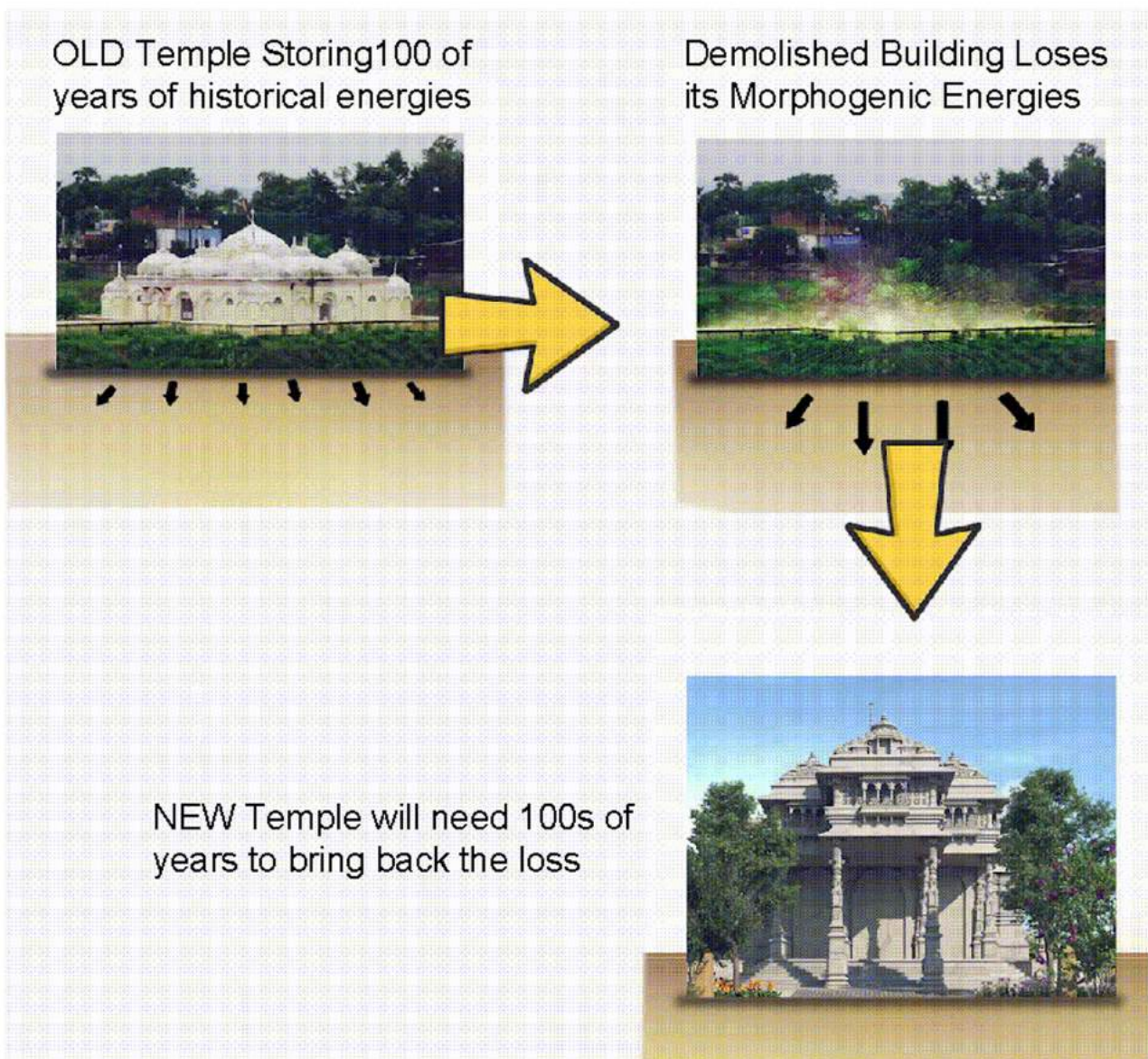



These vibrations come through ritualistic activities such as Pooja, Dhyaan, Daan, etc. Old temples are hubs of such memories and shall be either conserved or protected by people

An old building that was a Siddha Kshetra, a structure that had historical vibrations of Tirthankaras and Siddhas, were demolished.

The new building on the very same spot have not utilised the morphogenic energies of that space. The old temple was made of stone and lime only, allowing it to store these energies.

Vastuworld has found a way of holding the old energies, restoring them during construction and revitalize it after building is made for new audience. Hence, after the new construction, the building will still hold vibrations of Gautam Swami. This process occurs before the construction on site begins. This can be applied through science of sacred spaces, geopathy and geobiology, where we use the bio-resonance remedies. These remedies when applied at specific nodal points, evokes positivity and revokes lost energies.

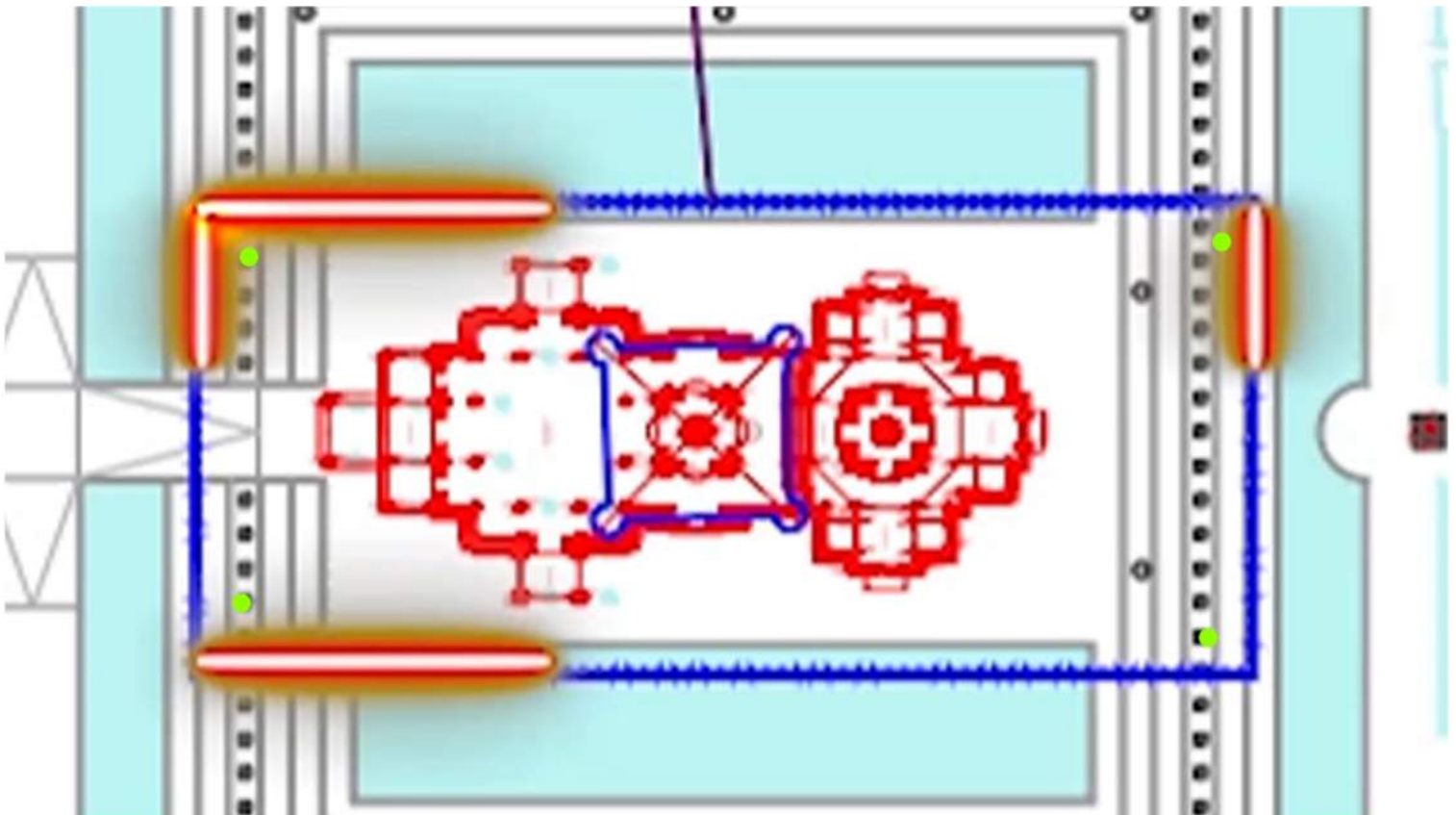

## Glimpses of December Workshop – Earth and Bio Energy Vastu – 7th.- 11th Dec 2022

Another amazing and totally knowledgeable workshop, lots of new information shared with hands on practice and site visit.



Demonstrating Dowsing Rods



Demonstrating Modula



Students learning about  
H3 Gold Lecher Antenna

## What was covered -

1. Identification of Geopathic stress & its effect on bio energies.
2. Hands on training using tools on Psychodynamic physical dowsing.
3. Analysis of Earth energies on drawings using paper dowsing.
4. Geo stress mapping on paper and analysis.
5. Understanding the scientific principles of Vedic Vastu Shastra.
6. Science of bio energies.
7. Human energy measurements using H3 Gold Lecher Antenna.
8. Decoding the energetic blockage and solutions.
9. Utilizing the science of environmental energy rectification as solutions to enhance well being.
10. Practical demonstration of Earth Magnetometer, Geo stress meter, Esmog Spion – to measure Earth energies and EMF radiations.
11. Geo stress mapping of Bali project on paper and on site – Discussion with actual video footage.
12. Site Visit – actual installation of remedies on an Industrial site .

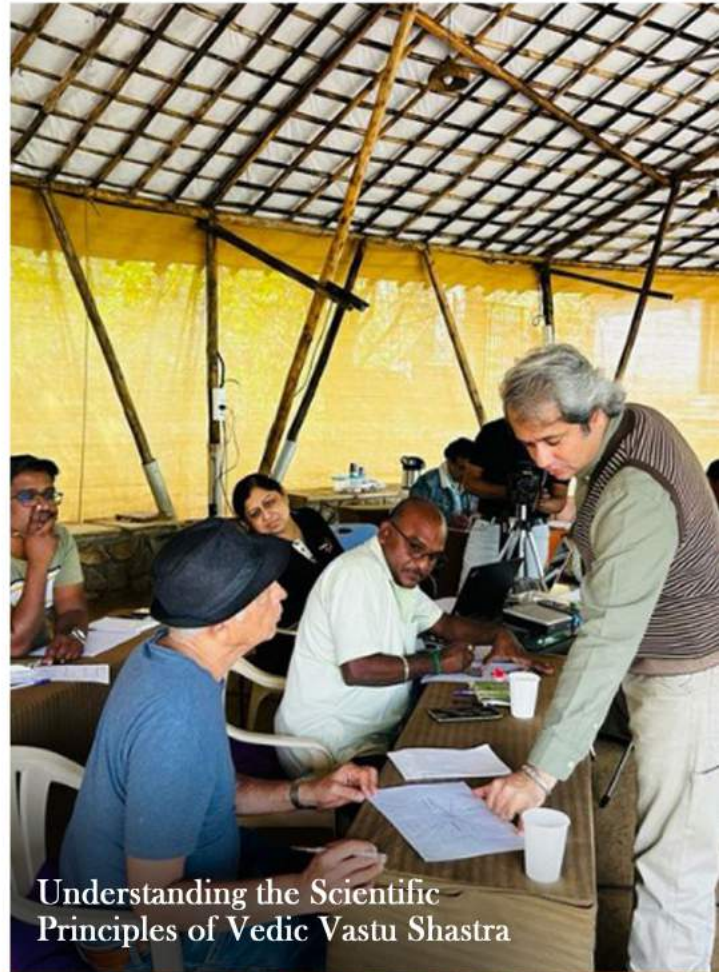

## 2nd International Jain Conference on Forgiveness – 21st.- 22nd.Jan 2023

Ar Mayank Barjatya was one of the key speaker at 2nd International Jain Conference on Forgiveness – 21st and 22nd Jan 2023 at Gujarat University, Ahmedabad, India.

Forgiveness and Architecture –

A Very interesting and totally relevant topic in today's times.





People gathering around Vastuworld Enclosure



Seeking blessings from Muni Shri Mrugendra Vijay Maharaj Saab



# On the occasion of Enthuva 2023 at Brick School of Architecture, Pune - Delivered an amazing yet heartfelt speech on Ar. BV Doshi Sir - A Few Glimpses

**ENTHUYA**  
2023

## — ANNUAL EXHIBITION —

**BRICK WORKS**

Presentation and inauguration by  
Chief Guest Ar. Mayank Barjatya



**Ar. Mayank Barjatya**

Bioenergetician & Building Biologist  
at Vastuworld & Bio-Architect at  
Prithwe: Earth & Us

A pioneer in Building Biology and Human Energetics, Ar. Mayank Barjatya is a Vastu consultant, who graduated with a Bachelor of Architecture from Pune University. He started Vastuworld in 2000 with a background in architecture, scientific and esoteric aspects of bioenergetics. Besides getting the Gold Lecher Antenna to India, he was selected by Vastu Shilpa Consultancy under Ar. B. V. Doshi for Amaravati's Capital Complex Design. He has also been awarded for his research on the Science of Bhaktamar Stotra. His work has taken him to the G-20 Bali Indonesia summit and has made him a part of academic committees & architecture panels.

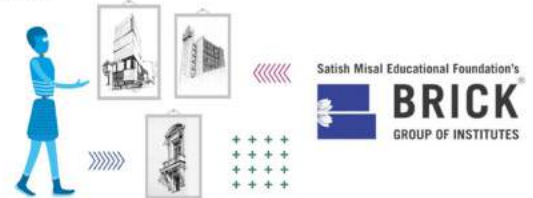

Date: Sunday, 5th February 2023 | Time: 9:30 AM onwards

Dr. Pooja Misal  
Founder Director

Ar. Akshay Gandhi  
Faculty Co-ordinator

Ar. Anurakti Yadav  
Faculty Co-ordinator

ID. Harshada Bhutada  
Faculty Co-ordinator



Welcomed by the Students  
at Brick



Speaking about B.V. Doshi sir



Students, Teachers and Staff at Brick

# Launch of Ashtamangal Energy Amplifier

Each of the Ashtamangal objects are auspicious-

Each of these objects has its own significance and inherent deeper meaning and all put together ushers in auspiciousness.

## ASHTAMANGAL ENERGY AMPLIFIER

**Magnify & Multiply the positive energies  
of your home !**

**Ashtamangal Door Frame - Above  
the main door, on the outer sider, or  
even on the wall.**

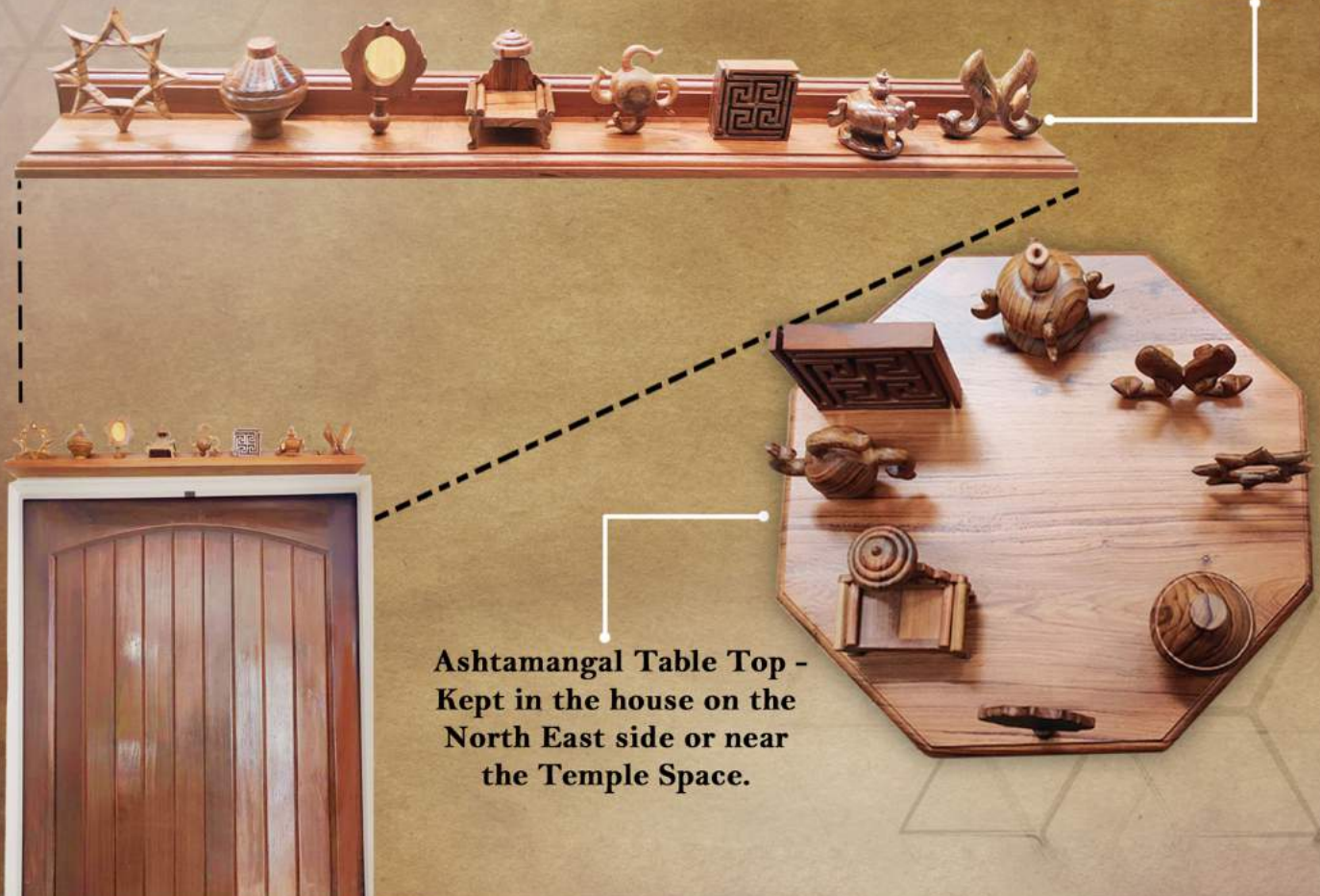

**Ashtamangal Table Top -  
Kept in the house on the  
North East side or near  
the Temple Space.**



It helps to magnify and multiple the positive energy devoid of obstacles or difficulties, it also denotes a state of protection

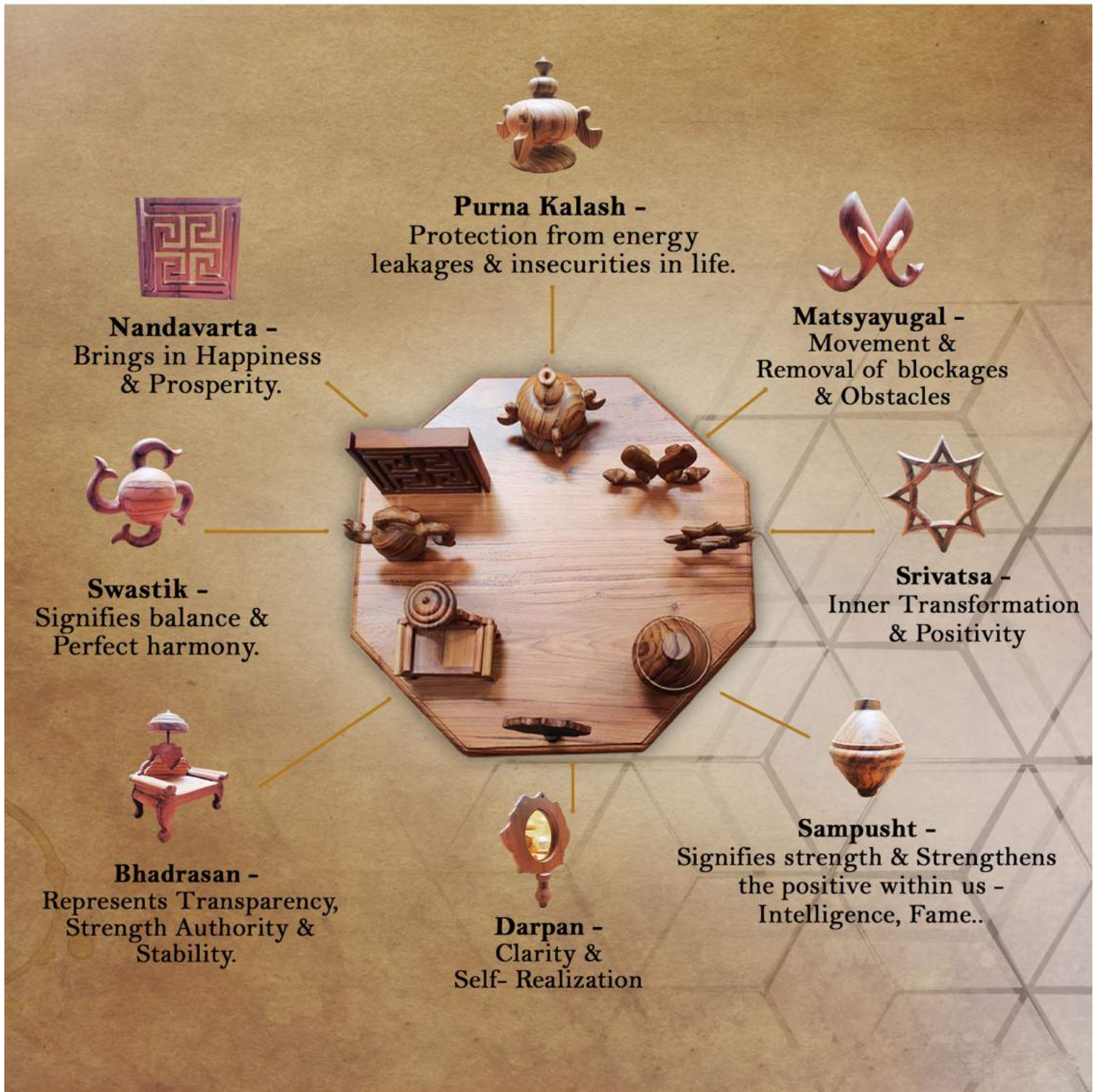

# We have RELOCATED-

Vasuworld has shifted it's office to Vastuworld, Bungalow No. 14, Sopan Baug, Pune -411001





@vastuworld



@48infinity\_bhaktamar\_energy

@Prithweearthcentre



@Energy Architecture



Vastuworld

Mayank Barjatya



9822573102t

[www.vastuworld.com](http://www.vastuworld.com)



[www.vastuworldlearning.com](http://www.vastuworldlearning.com)

[www.prithwe.com](http://www.prithwe.com)

[www.48infinity.com](http://www.48infinity.com)